

Courtesy Of Rohin Geis and Victor Moroz Of Royal LePage Noralta Real Estate

\$574,999 - 6 52111 Range Rd 270, Rural Parkland County

MLS® #E4407988

\$574,999

0 Bedroom, 0.00 Bathroom,
Land Commercial on 0.00 Acres

Sandhills Estates, Rural Parkland County, AB

Prime Development Opportunity in Edmonton Parkland Executive Airport! Seize the chance to own a 0.6-acre lot in the Edmonton Parkland Executive Airport, located on the North side of the development, offering proximity to the runway. With paved taxiways, Natural gas and Power to the lots, this parcel provides an ideal foundation for various hangar or shop configurations to meet your specific needs. Each lot will require an independent septic and cistern system. Zoned AGG, this versatile lot offers flexibility for aviation-related or other commercial developments.



Essential Information

| | |
|-----------|-----------------|
| MLS® # | E4407988 |
| Price | \$574,999 |
| Bathrooms | 0.00 |
| Acres | 0.00 |
| Type | Land Commercial |
| Status | Active |

Community Information

| | |
|-------------|-----------------------|
| Address | 6 52111 Range Rd 270 |
| Area | Rural Parkland County |
| Subdivision | Sandhills Estates |

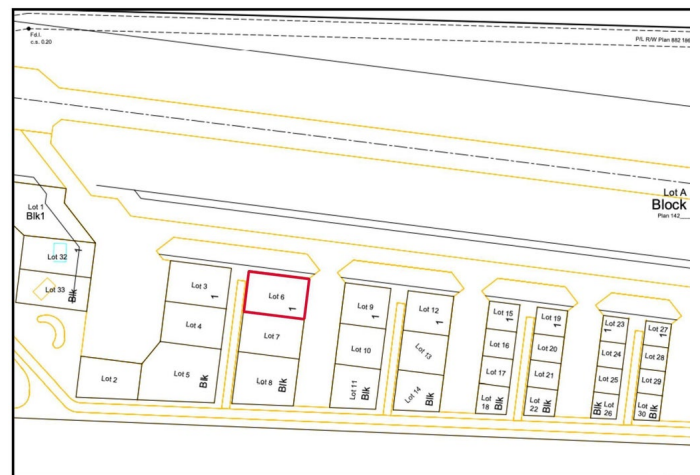

| | |
|-------------|-----------------------|
| City | Rural Parkland County |
| County | ALBERTA |
| Province | AB |
| Postal Code | T7X 3M2 |

Additional Information

| | |
|----------------|----------------------|
| Date Listed | September 26th, 2024 |
| Days on Market | 198 |
| Zoning | Zone 90 |

DATA IS DEEMED RELIABLE BUT IS NOT GUARANTEED ACCURATE BY THE REALTORS® ASSOCIATION OF EDMONTON. COPYRIGHT 2025 BY THE REALTORS® ASSOCIATION OF EDMONTON. ALL RIGHTS RESERVED. Trademarks are owned or controlled by the Canadian Real Estate Association (CREA) and identify real estate professionals who are members of CREA (REALTOR®, REALTORS®) and/or the quality of services they provide (MLS®, Multiple Listing Service®)

Listing information last updated on April 12th, 2025 at 4:32am MDT